



How to make comments

You need fill out only one copy of your contact details. However, **please fill in a separate response form for each site or issue that you wish to comment on.** Please indicate in the box provided on the contact details form the total number of pages enclosed. Please complete the attached Equality Monitoring Form if you wish.

An electronic copy of this form is available at www.southlakeland.gov.uk/landallocations

Electronic forms or responses by email can be sent to developmentplans@southlakeland.gov.uk.

Responses on paper copies of this form should be posted or faxed to:

Development Strategy Manager
South Lakeland District Council
South Lakeland House
Lowther Street
Kendal
LA9 4DL

Fax: 01539 717355

You may also hand in your form to the council offices at:

- South Lakeland House, Lowther Street, Kendal; or
- Ulverston Local Link (Town Hall)

If you require additional copies of the form please call 01539 717490 or email developmentplans@southlakeland.gov.uk.

Internet access is available at your local library and at South Lakeland House, Kendal.

Please ensure that your comments reach the Council Offices at South Lakeland House, Kendal no later than Friday 9th September 2011.

Your contact details and privacy

Anonymous comments will not be accepted. Comments cannot be treated as confidential and will be available for public inspection. Your submitted comments will be used in the preparation of the LDF.

Contact details, signatures and private addresses will not be made public. Any data that you supply will be held in accordance with the Data Protection Act 1998.

Viewing the relevant documents

The consultation document, which includes maps of the sites we would like comments on can be viewed at council offices and local libraries and downloaded from the Council website

Any questions?

If you need help completing the comments sheet, require further information or are unsure about any aspect of the consultation, our Development Plans Team will be pleased to advise.

Contact details are:

Tel: **01539 717490**

Email: developmentplans@southlakeland.gov.uk



Consultation Response Form

Your contact details

If you are completing a paper copy of this form please use CAPITALS and BLACK INK.

Your details		Your Agent's details (if you have one)	
Organisation: United Utilities Property Services		Organisation: N/A	
Name: Andrew Leysens		Name:	
Address: First Floor, Grasmere House, Lingley Mere Business Park, Lingley		Address:	
Green Avenue, Warrington			
Postcode:	WA5 3LP	Postcode:	
Tel: 01925 731 285		Tel:	
*Email: andrew.leysens@uuplc.co.uk		*Email:	

*We aim to minimise the amount of paper printed and sent out. Therefore, where an email address is supplied, future contact will be made electronically.

This response contains pages including this one.



Please tick the box if you would like us to notify you when the Land Allocations Development Plan Document is submitted to the Secretary of State for independent examination and when it is adopted by the Council.

Land Allocations - Further Consultation

Please use this form to comment on:

1. Alternative sites put forward by respondents to the earlier Land Allocations consultation (January - April 2011);
2. Time span of the Land Allocations document
3. The approach to development in small villages, hamlets and the countryside.

Please complete one of these sheets for every response you make.

(Please also note that comments made in earlier consultation need not be repeated.)

1. Alternative Sites

Please let us have your views on alternative sites suggested by respondents to the previous consultation. (Please note, these are not SLDC suggestions.)

Which site do you wish to comment on?		
Settlement (e.g. Natland)	Site reference number (e.g. RN298#)	
Please indicate below whether you support, support in part or oppose the suggestion that this site be included in the Land Allocations document (please tick as appropriate)		
Support <input type="checkbox"/>	Support in part <input type="checkbox"/>	Oppose <input type="checkbox"/>
Please explain your reasons/add your comments below (continue on a separate sheet/expand box if necessary)		
No comment from Property Services section of United Utilities on the additional suggested sites.		

2. Time Span of Land Allocations Document:

Should the Land Allocations document plan period remain 2003 – 2025 or cover a shorter period, for example, 2003-2020?

Please indicate whether you support, support in part or oppose a reduction in the time span of the Land Allocations document (please tick as appropriate)

Support

Support in part

Oppose

Please explain your reasons/add your comments below (continue on a separate sheet/expand box if necessary)

The Property Services section has no particularly comment on the reduction in time span of the land allocations document.

From an infrastructure provider viewpoint, there is a need to make it clear how development will be phased if the time span is shortened or retained. An understanding of the phasing of development over the plan period is especially important for water and sewerage companies given the five year funding regimes which dictate capital investment programmes in the water industry. By understanding the timing of development, water and sewerage companies can co-ordinate investment in infrastructure to ensure that the right investment is made at the right time to service the infrastructure needs of development.

3. Small Villages, Hamlets & Open Countryside

Do you think the future housing and employment land needs of small villages, hamlets and open countryside are best met by: -

- A. Allocating sites for houses and employment in the Land Allocations document; or
- B. Communities and/or developers bringing forward sites for housing and employment for consideration under relevant Core Strategy policies, through neighbourhood plans and/or other local initiatives.

Please indicate which of the above options you would support. (Please tick as appropriate)

A

B

Please explain your reasons/add your comments below (continue on a separate sheet/expand box if necessary)

The future housing and employment land needs of small villages, hamlets and open countryside are best met by allocating sites for houses and employment in the Land Allocations document. The allocation of sites provides infrastructure providers with a greater degree of certainty over where development will occur. As a result, infrastructure investment decisions can be better co-ordinated with development plan proposals. In contrast it is very difficult to co-ordinate infrastructure delivery in rural areas where development is delivered on a windfall basis. It should be noted that very small proposals can have a significant impact on small infrastructure facilities which are built to serve only small settlements.

Thank you for your views and suggestions.

This page is intentionally blank

CONFIDENTIAL

EQUALITY MONITORING FORM (completion of this form is voluntary)

South Lakeland District Council is committed to ensuring an excellent quality of service for all. To help us to achieve this, please complete the questions below. If you choose not to answer these questions it will not make any difference to the service you receive. Responses will be used to provide statistical information for the council to check the fairness of any services you receive. This form is anonymous and will be used by SLDC.

Please tick boxes as appropriate:

1. Ethnicity

Do you consider yourself to be:-

		Tick			Tick
White	British		Mixed	White & black Caribbean	
	Irish			White & black African	
	Gypsy Traveller / Romany			White and Asian	
	Irish Traveller			Any other Mixed background, please state	
	Other White European EU or Non EU				
	Any other white background Please state.....		Black or black British	Caribbean	
			African		
			Any other black background please state		
Asian or Asian British	Indian		Chinese or other Ethnic groups	Chinese	
	Pakistani			Philippine	
	Bangladeshi			Other.....	
	Any other Asian background Please state.....		Undeclared		

2. Disability

Do you consider yourself to have:

A disability	
A long term limiting condition that affects health	
A long term limiting condition that does not affect health	
Undeclared	
Other	

3. Gender

Are you:

Male	
Female	
Undeclared	

4. Age

Are you:

0-15		40-49	
16-19		50-59	
20-29		60 and over	
30-39		undeclared	

5. Sexuality

Do you identify as:

Heterosexual	
Gay	
Lesbian	
Bi-sexual	
Undeclared	

6. Religion / belief

Are you:

Buddhist	
Christian	
Hindu	
Jewish	
Muslim	
Sikh	
Non-religious	
Other, please state	
Undeclared	

7. Permanent Residence Please indicate your postal code:	
---	--

If you would like a copy of this document in another format such as Large print, Braille, Audio or in a different language, please **0845 050 4434** or email **customerservices@southlakeland.gov.uk**



LAND AT MEAL BANK MILL

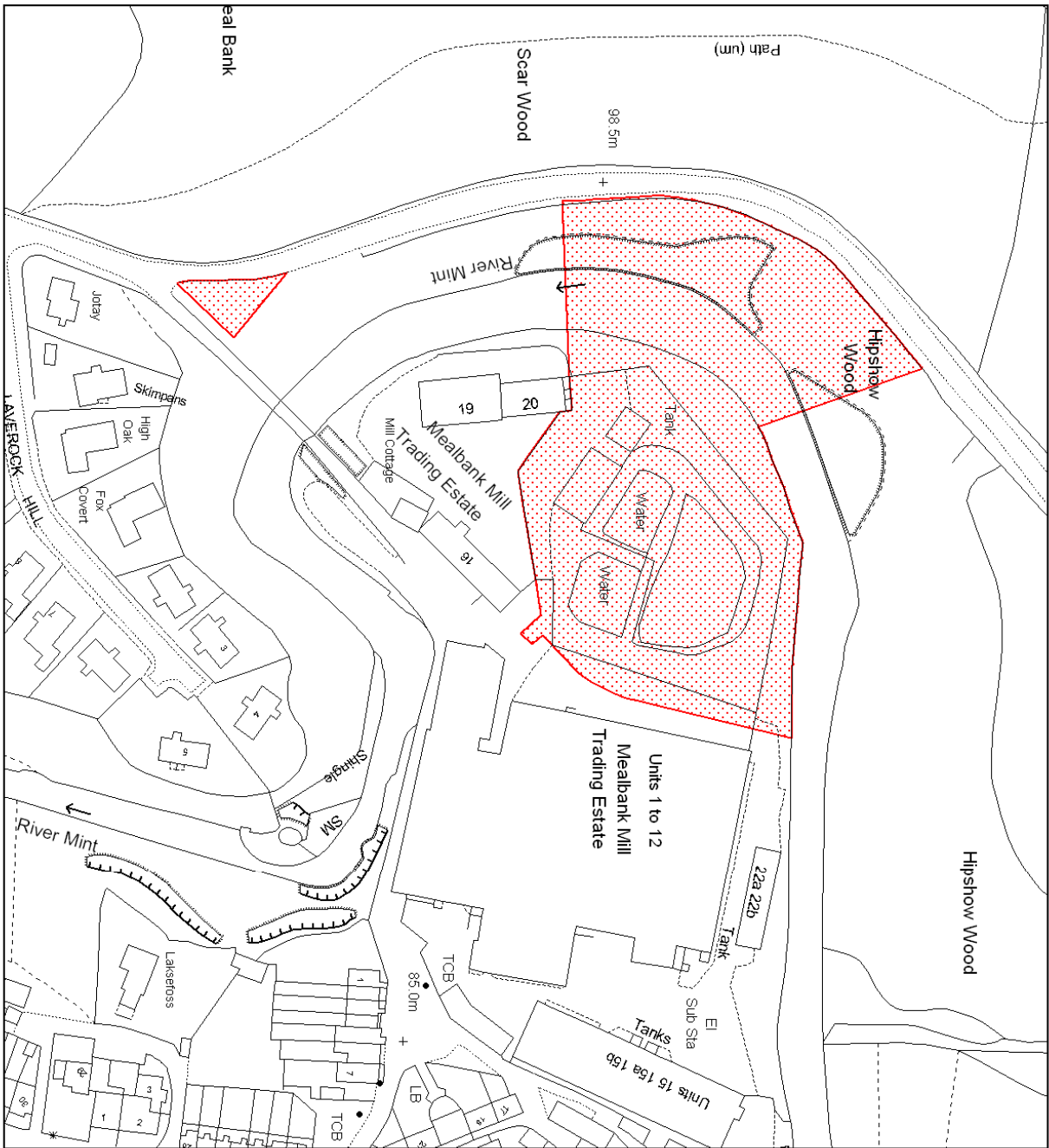

NGR: SD 539 957

Scale 1:1,250

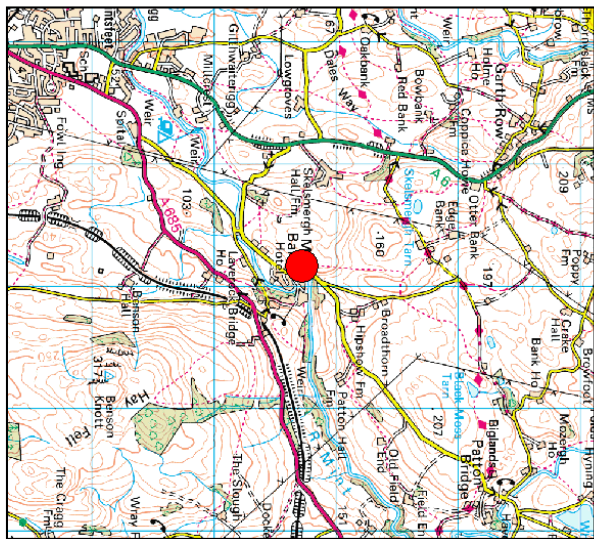

Location Plan

Scale 1:50,000

● - Location of Property

COPYRIGHT ACKNOWLEDGEMENT
 THIS PLAN IS BASED UPON THE ORDINANCE SURVEY MAP BY NWL LTD WITH THE SANCTION OF THE CONTROLLER OF H.M. STATIONERY OFFICE.
 CROWN COPYRIGHT RESERVED. UNAUTHORISED REPRODUCTION INFRINGES COPYRIGHT.



THREE BRIDGES SEPTIC TANK, ULVERSTON

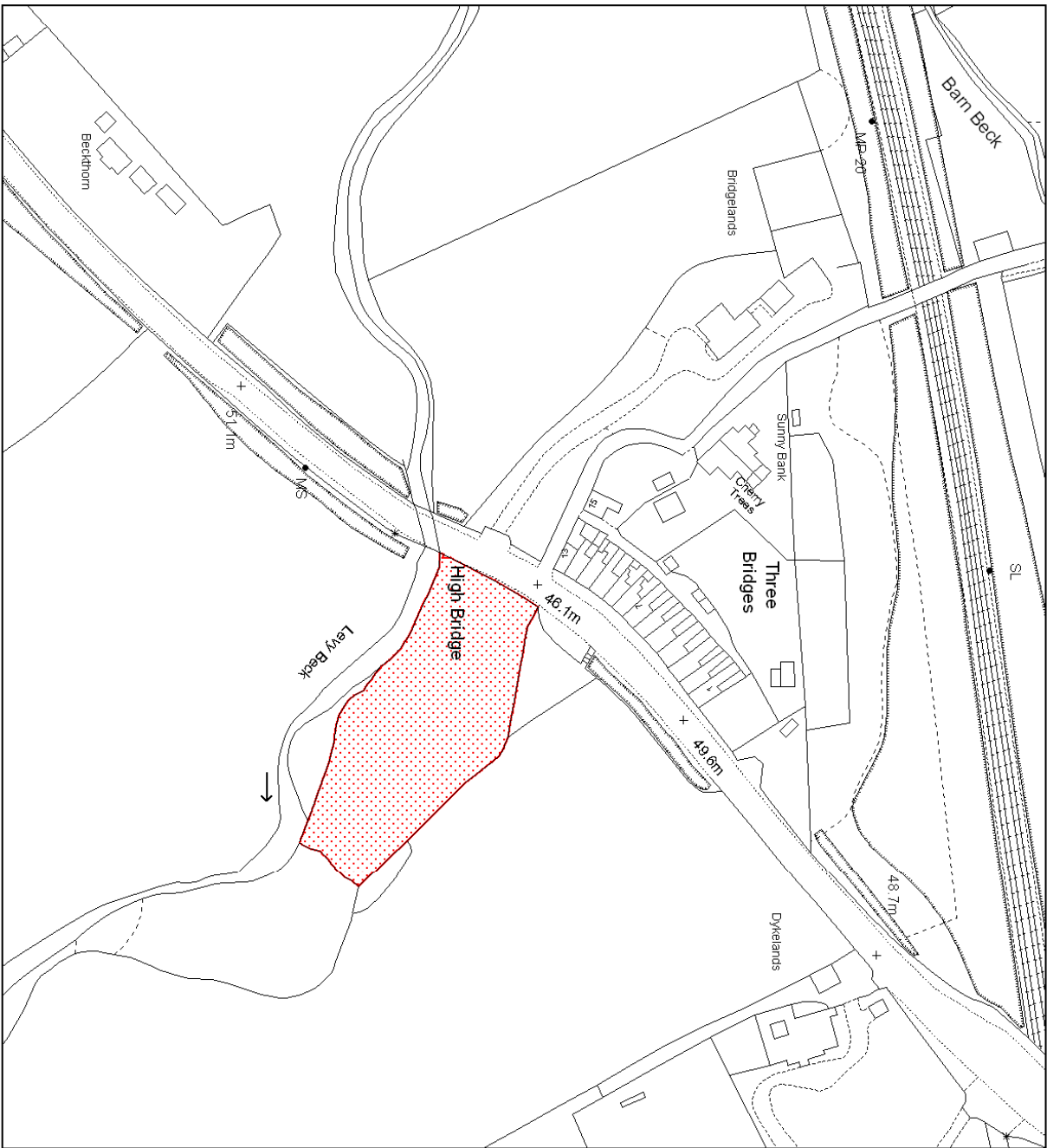

NGR: SD 275 775

Scale 1:500

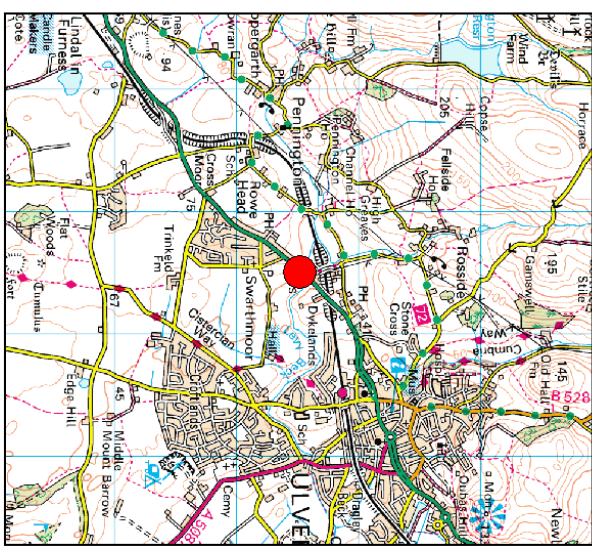

Location Plan

Scale 1:50,000

● - Location of Property

COPYRIGHT ACKNOWLEDGEMENT
 THIS PLAN IS BASED UPON THE ORDINANCE SURVEY MAP BY NWM LTD WITH THE SANCTION OF THE CONTROLLER OF H.M. STATIONERY OFFICE.
 CROWN COPYRIGHT RESERVED. UNAUTHORISED REPRODUCTION INFRINGES COPYRIGHT.



MOUNT PLEASANT BALANCING TANK, ARNSIDE

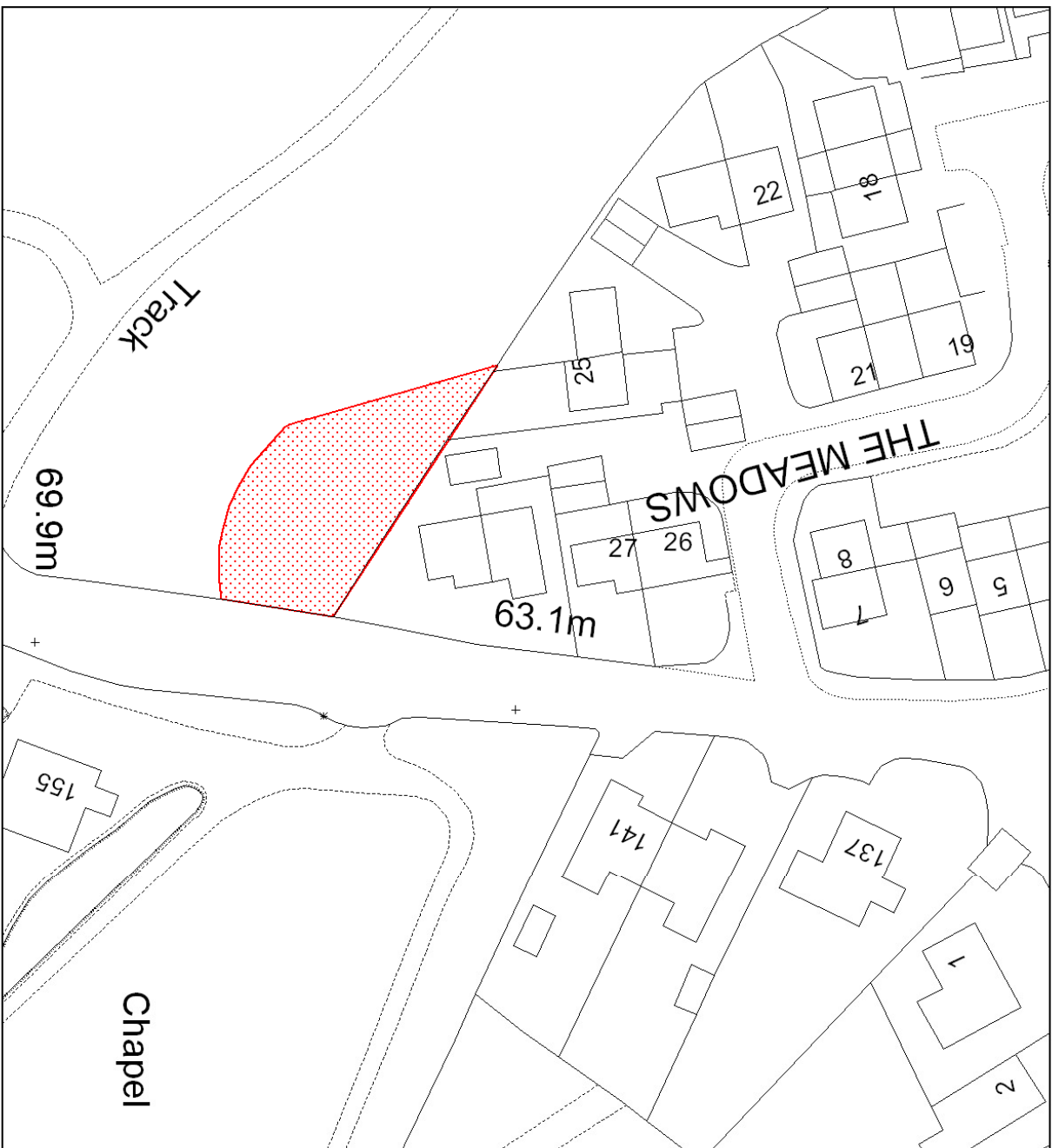

NGR: SD 460 777

Scale 1:500

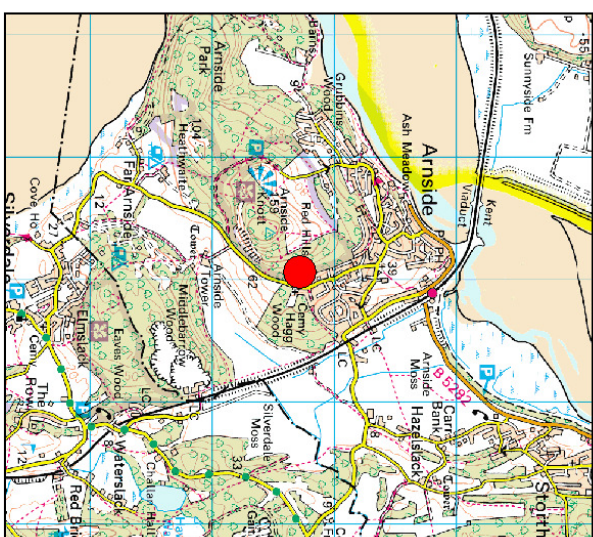

Location Plan

Scale 1:50,000

● - Location of Property

COPYRIGHT ACKNOWLEDGEMENT
 THIS PLAN IS BASED UPON THE ORDNANCE SURVEY MAP BY NWM LTD WITH THE SANCTION OF THE CONTROLLER OF H.M. STATIONERY OFFICE.
 CROWN COPYRIGHT RESERVED. UNAUTHORISED REPRODUCTION INFRINGES COPYRIGHT.

