

Do not scale from this drawing. Only figured dimensions are to be taken from this drawing.  
The contractor must verify all dimensions on site before commencing any work or shop drawings.  
The contractor must report any discrepancies to post date design to before commencing work. If this drawing exceeds the quantities taken in any way, post date design is to be informed before the work is initiated.  
Distance survey information is used on post date design drawings, and when design is a not boundary of the nearest topographic survey data, or any Ordnance Survey data, or beyond the boundary of the nearest topographic survey data.  
While using The Contractor's Design and Management (Regulation 2008) is not to start until a Health and Safety Plan has been produced.  
COPYRIGHT © post date design ltd  
This drawing is copyright and must not be reproduced in any format or media without written consent of post date design ltd.



Legend

- Site boundary (approx 4.64 ha)
- Main developable area (approx. 4.25 ha- excl Central POS)
- Central open space (approx 0.2 ha)
- Amenity open space to west (approx 0.11ha)
- Existing buildings
- Proposed built form
- Key frontages at entrance points / around squares etc.
- Existing vegetation
- Proposed vegetation
- A65: Main Street
- Proposed primary accesses / main development streets
- Proposed lower category streets
- Proposed shared surface / private drive
- Existing Public Right of Way
- Proposed key footway links

**Development Shown.**  
Site area as shown measures 4.64 ha / 11.47 ac.  
Site development as highlighted accommodates around 100-105 units generating a site-wide density of approximately 22 dph or 25 dph excluding areas of open space.



REV X - - - - - REVISION NOTE

**POD**  
99 galgate  
barnard castle  
county durham  
DL12 8EJ  
01273 7288  
e: info@poddurhamcastle.co.uk  
also at: office factory, newcastle-upon-tyne, NE1 2DF

**PROJECT:**  
Land north of Sycamore Close,  
Endmoor, Kendal

**DRAWING TITLE:**  
Initial Development  
Framework Plan

CLIENT:	DATE:
Story Homes	04/12
STATUS:	DRAWN BY: AC
FEASIBILITY	CHECKED BY: AD
SCALE:	SHEET SIZE: A1
1:10000	REVISION:
PROJECT NO: STO - 275	DRAWING NO: 01-01



Approaching the site from the south along A65 corridor



Approaching the site and the village from the north along A65



Looking towards site through playground and school grounds



Eastern margin of the site adjacent to low density housing framed by substantial landscaping



Panoramic view across the site looking from the northern site boundary towards the village with school and adjacent Sycamore Close housing development in distance (to right of view)



Aerial photograph highlighting site boundary and context



Local built form



Local built form



Local built form



Local built form



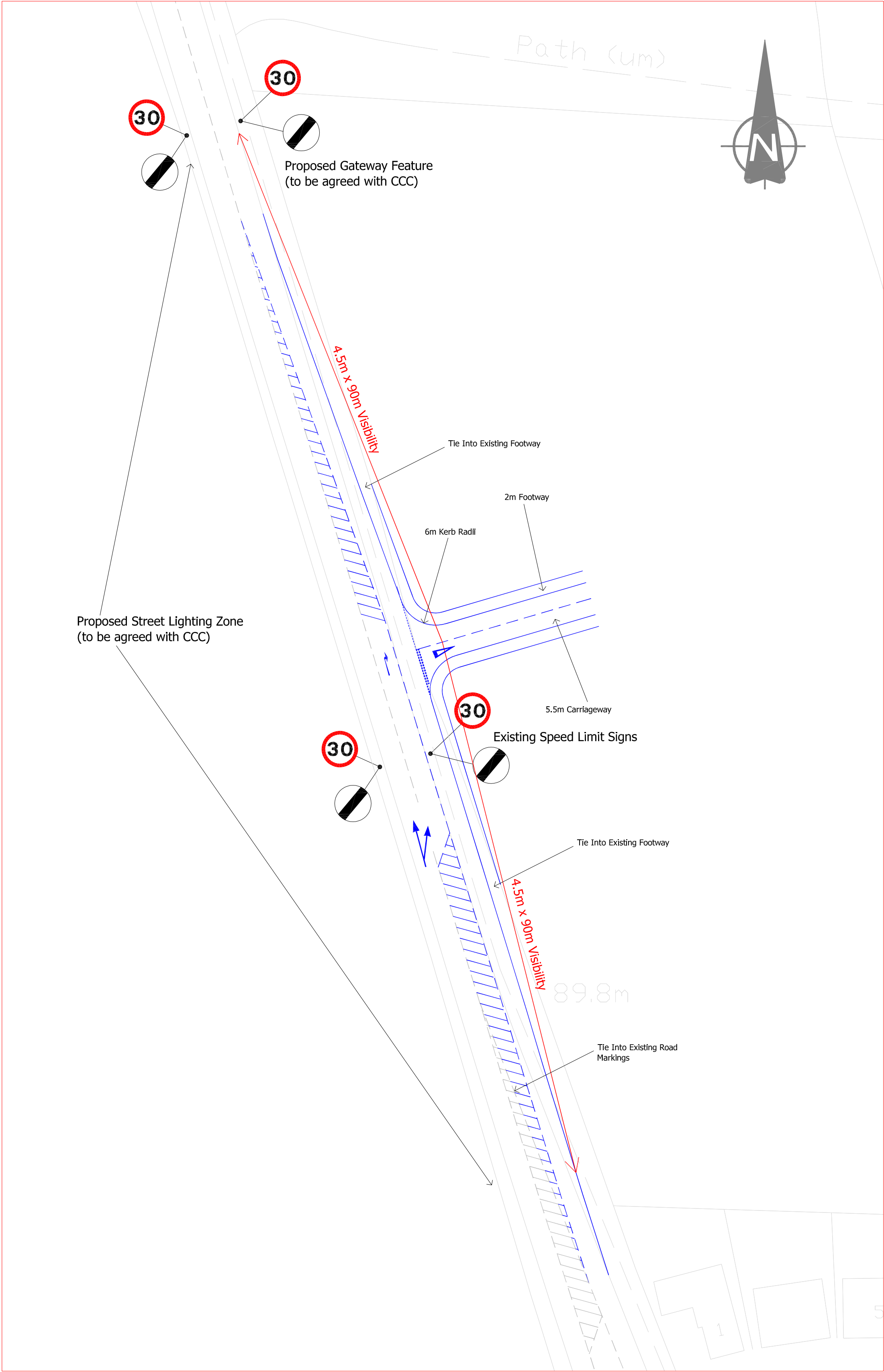

B	Visibility Splay Amended & Street Lighting Columns Proposed	GW	AA	AA	14.03.12
A	Modifications to access junction	GW	AA	AA	13.03.12
REV	DESCRIPTION	BY	CHK	APP	DATE

Client

STORY LAND

2 St. JAMES GATE  
NEWCASTLE UPON TYNE  
TYNE & WEAR  
NE1 4AD

TEL: +44 (0)191 255 7300  
FAX: +44 (0)191 255 7301  
e-mail: newcastle@wyg.com



Project:

ENDMOOR, KENDAL

Drawing Title:

PROPOSED SITE ACCESS JUNCTION

Scale @ A2 1:500 @ A3	Drawn GW	Date 23.02.12	Checked AA	Date 24.02.12	Approved NB	Date 24.02.12
Project No. A075423	Office 37	Type 18	Drawing No. C001	Revision B		